

Passenger Speed (BNSF)
 Freight Speed (BNSF)
 Passenger Speed (PVL)

- NOTES:**
1. NEW CONSTRUCTION - REFERS TO A NEW TRACK CONSTRUCTED WHERE THERE IS NO TRACK AT PRESENT.
 2. TRACK UPGRADES - REFERS TO A COMPLETE REPLACEMENT OF THE EXISTING TRACK WITH NEW 136 LB CWR AND CONCRETE TIES.
 3. EXISTING MAIN TRACK - REFERS TO TRACKS THAT REMAIN IN PLACE; IF NECESSARY THE TRACK STRUCTURE WILL BE IMPROVED THROUGH SELECTIVE REPAIR, REHABILITATION, AND/OR REPLACEMENT OF TURNOUTS, ROAD CROSSINGS, BALLAST, AND CROSS TIES.
 4. ALL FREIGHT SPEEDS ARE CURRENT TIME TABLE SPEEDS.

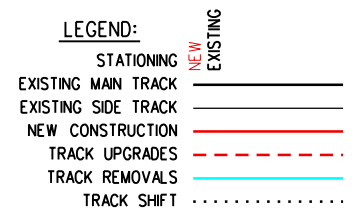

5/15/2009 6:55:45 AM USER = Acraft
 J:\Projects\Stv\Drawings\W-206-S-W-201.sht
 J:\Caddconfig\PLT\Drivers\SCRRA_PDF_Color_Halft.plt

NOT FOR CONSTRUCTION

REV.	DATE	DESCRIPTION	BY	APP.
5-19-09		PRELIMINARY (30%) DESIGN		

INFORMATION CONFIDENTIAL
 All plans, drawings, specifications, and/or information furnished herewith shall remain the property of the Riverside County Transportation Commission and shall be held confidential and shall not be used for any purpose not provided for in agreements with the Riverside County Transportation Commission.

DESIGNED BY
R. ITURALDE

DRAWN BY
R. ITURALDE

CHECKED BY
P. MAHONEY

APPROVED BY
MZ. GHANDEHARI

DATE
5-19-09

RCTC RIVERSIDE COUNTY TRANSPORTATION COMMISSION

STV Incorporated
 ENGINEERS/ARCHITECTS/PLANNERS/CONSTRUCTION MANAGERS
 9130 ANAHEIM PLACE, SUITE 210
 RANCHO CUCAMONGA, CA. 91730-8540

PATTERSON ASSOCIATES, INC.
 725 TOWN & COUNTRY RD
 SUITE 300
 ORANGE, CA 92668

RCTC PERRIS VALLEY LINE

SCHEMATIC SHEET 1 OF 6

CONTRACT NO. C07-33-123-00	
DRAWING NO. S	DISCIPLINE/SEQUENCE W-201
REVISION	SHEET NO. 38 OF 1140
SCALE NOT TO SCALE	

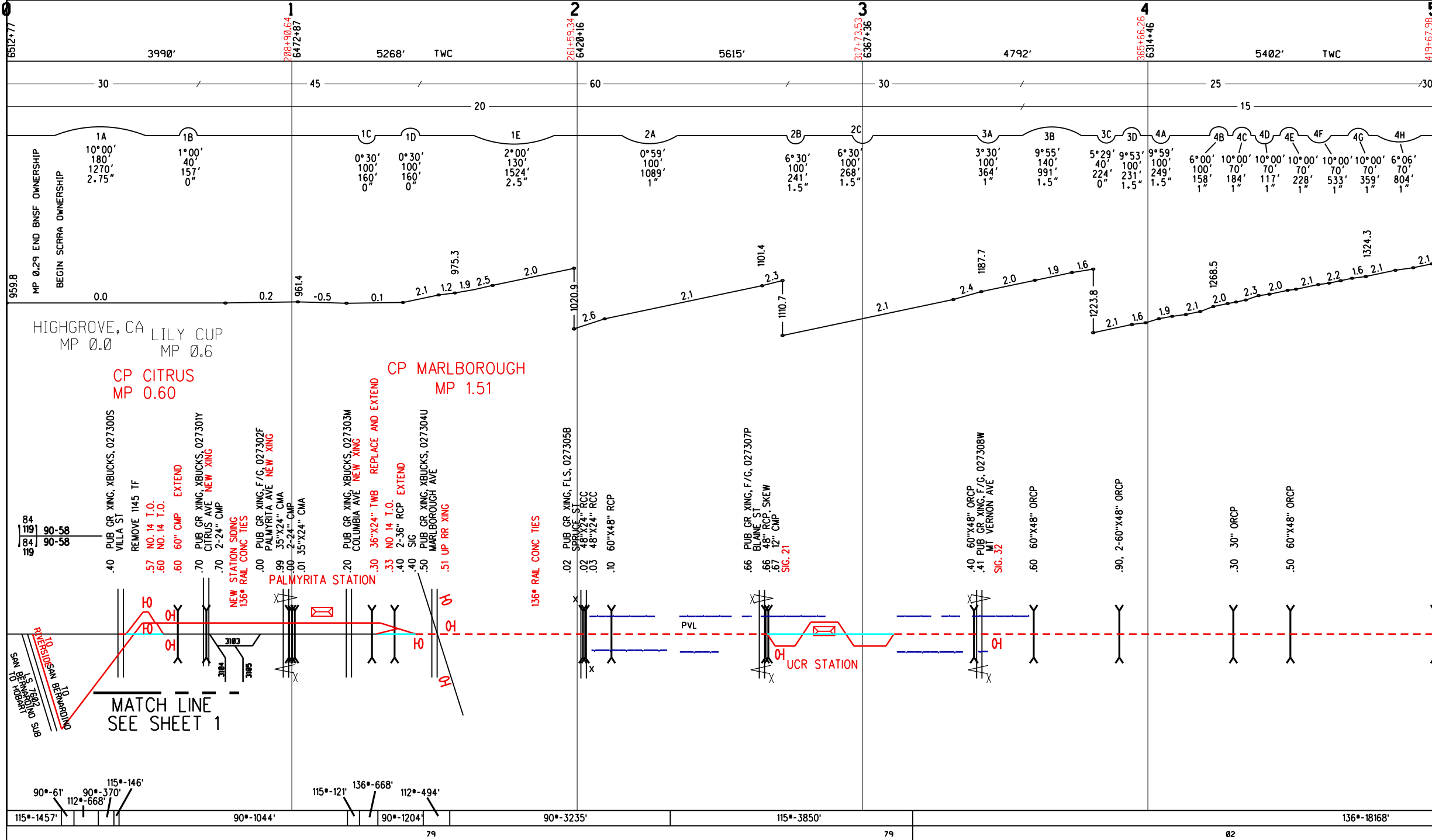

Passenger Speed
Freight Speed

- NOTES:**
1. NEW CONSTRUCTION - REFERS TO A NEW TRACK CONSTRUCTED WHERE THERE IS NO TRACK AT PRESENT.
 2. TRACK UPGRADES - REFERS TO A COMPLETE REPLACEMENT OF THE EXISTING TRACK WITH NEW 136 LB CWR AND CONCRETE TIES.
 3. EXISTING MAIN TRACK - REFERS TO TRACKS THAT REMAIN IN PLACE; IF NECESSARY THE TRACK STRUCTURE WILL BE IMPROVED THROUGH SELECTIVE REPAIR, REHABILITATION, AND OR REPLACEMENT OF TURNOUTS, ROAD CROSSINGS, BALLAST, AND CROSS TIES.
 4. ALL FREIGHT SPEEDS ARE CURRENT TIME TABLE SPEEDS.

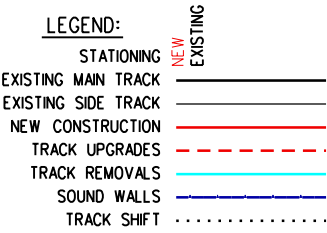

NOT FOR CONSTRUCTION

REV.	DATE	DESCRIPTION	BY	SUB.	APP.
5-19-09		PRELIMINARY (30%) DESIGN			

INFORMATION CONFIDENTIAL
All plans, drawings, specifications, and/or information furnished herewith shall remain the property of the Riverside County Transportation Commission and shall be held confidential and shall not be used for any purpose not provided for in agreements with the Riverside County Transportation Commission.

DESIGNED BY
R. ITURALDE

DRAWN BY
R. ITURALDE

CHECKED BY
P. MAHONEY

APPROVED BY
MZ. GHANDEHARI

DATE
5-19-09

RCTC RIVERSIDE COUNTY TRANSPORTATION COMMISSION

STV Incorporated
ENGINEERS/ARCHITECTS/PLANNERS/CONSTRUCTION MANAGERS
9130 ANAHEIM PLACE, SUITE 210
RANCHO CUCAMONGA, CA. 91730-8540

PATTERSON & ASSOCIATES, INC.
725 TOWN & COUNTRY RD
SUITE 300
ORANGE, CA 92668

RCTC PERRIS VALLEY LINE

SCHEMATIC SHEET 2 OF 6

CONTRACT NO. C07-33-123-00	
DRAWING NO. S	DISCIPLINE/SEQUENCE W-202
REVISION	SHEET NO. 39 OF 1140
SCALE	NOT TO SCALE

5/15/2009 6:55:46 AM USER = Acraft
J:\Projects\STV\N\Drawings\W-202-S-W-202.sht
J:\Caddconfig\PVL\Plot_Drivers\SCRRA_PDF_Color_Halft.plt

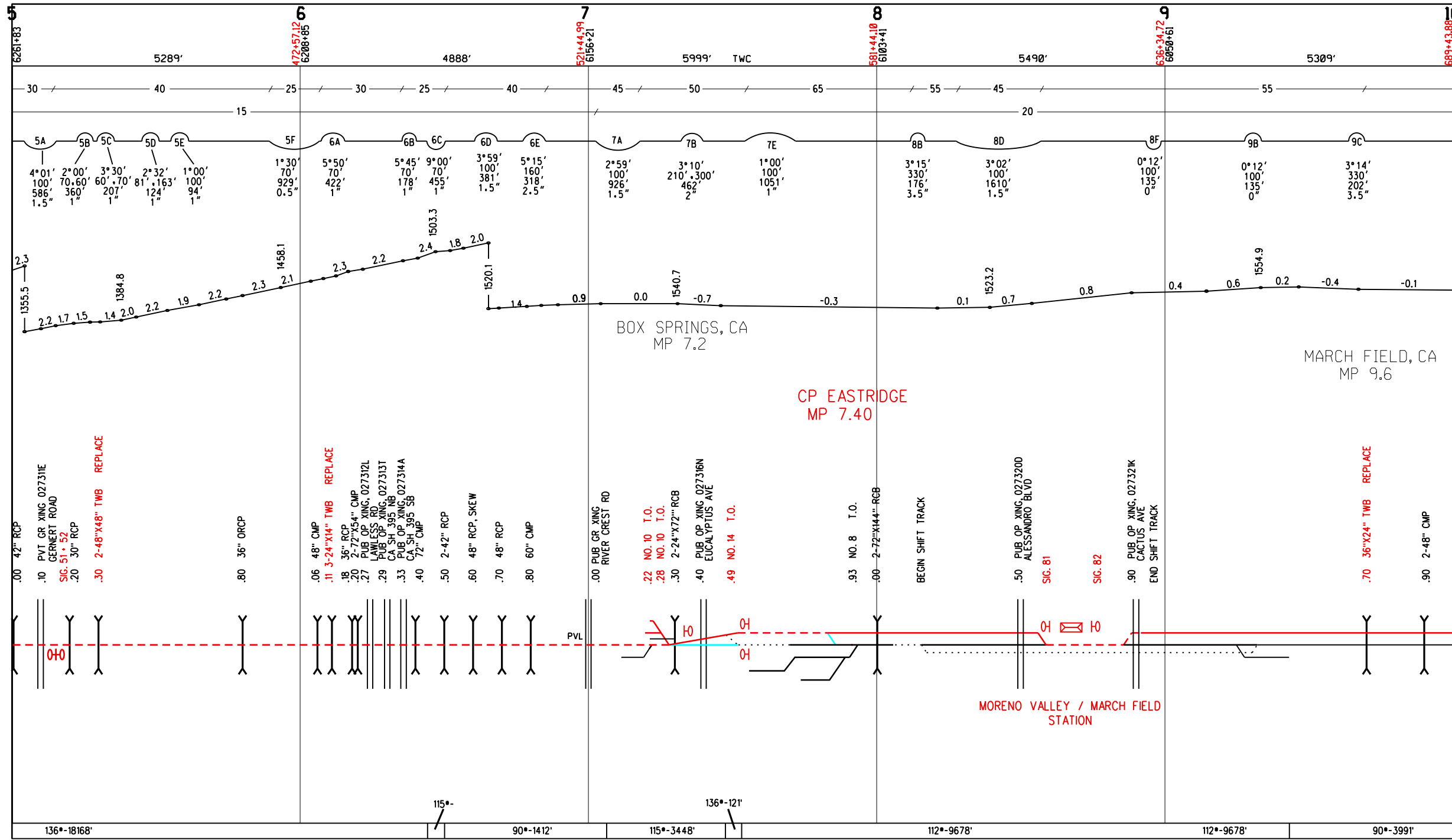

Passenger Speed
Freight Speed

- NOTES:**
1. NEW CONSTRUCTION - REFERS TO A NEW TRACK CONSTRUCTED WHERE THERE IS NO TRACK AT PRESENT.
 2. TRACK UPGRADES - REFERS TO A COMPLETE REPLACEMENT OF THE EXISTING TRACK WITH NEW 136 LB CWR AND CONCRETE TIES.
 3. EXISTING MAIN TRACK - REFERS TO TRACKS THAT REMAIN IN PLACE; IF NECESSARY THE TRACK STRUCTURE WILL BE IMPROVED THROUGH SELECTIVE REPAIR, REHABILITATION, AND OR REPLACEMENT OF TURNOUTS, ROAD CROSSINGS, BALLAST, AND CROSS TIES.
 4. ALL FREIGHT SPEEDS ARE CURRENT TIME TABLE SPEEDS.

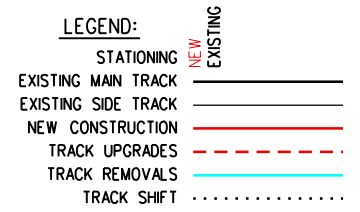

5/15/2009 6:55:48 AM USER = Aacoft
 J:\Projects\14\14\Drawings\14-06-5-W-203.sht
 J:\Caddconfig\14\14\Plot_Drivers\SCRRA_PDF_Color_Half.plt

NOT FOR CONSTRUCTION

REV.	DATE	DESCRIPTION	BY	APP.
5-19-09		PRELIMINARY (30%) DESIGN		

INFORMATION CONFIDENTIAL
 All plans, drawings, specifications, and/or information furnished herewith shall remain the property of the Riverside County Transportation Commission and shall be held confidential and shall not be used for any purpose not provided for in agreements with the Riverside County Transportation Commission.

DESIGNED BY
R. ITURALDE

DRAWN BY
R. ITURALDE

CHECKED BY
P. MAHONEY

APPROVED BY
MZ. GHANDEHARI

DATE
5-19-09

RCTC RIVERSIDE COUNTY TRANSPORTATION COMMISSION

STV Incorporated
 ENGINEERS, ARCHITECTS, PLANNERS/CONSTRUCTION MANAGERS
 9130 ANAHEIM PLACE, SUITE 210
 RANCHO CUCAMONGA, CA. 91730-8540

PATTERSON & ASSOCIATES, INC.
 725 TOWN & COUNTRY RD
 SUITE 300
 ORANGE, CA 92668

RCTC PERRIS VALLEY LINE

SCHEMATIC SHEET 3 OF 6

CONTRACT NO. C07-33-123-00	
DRAWING NO. S	DISCIPLINE/SEQUENCE W-203
REVISION	SHEET NO. 40 OF 1140
SCALE	NOT TO SCALE

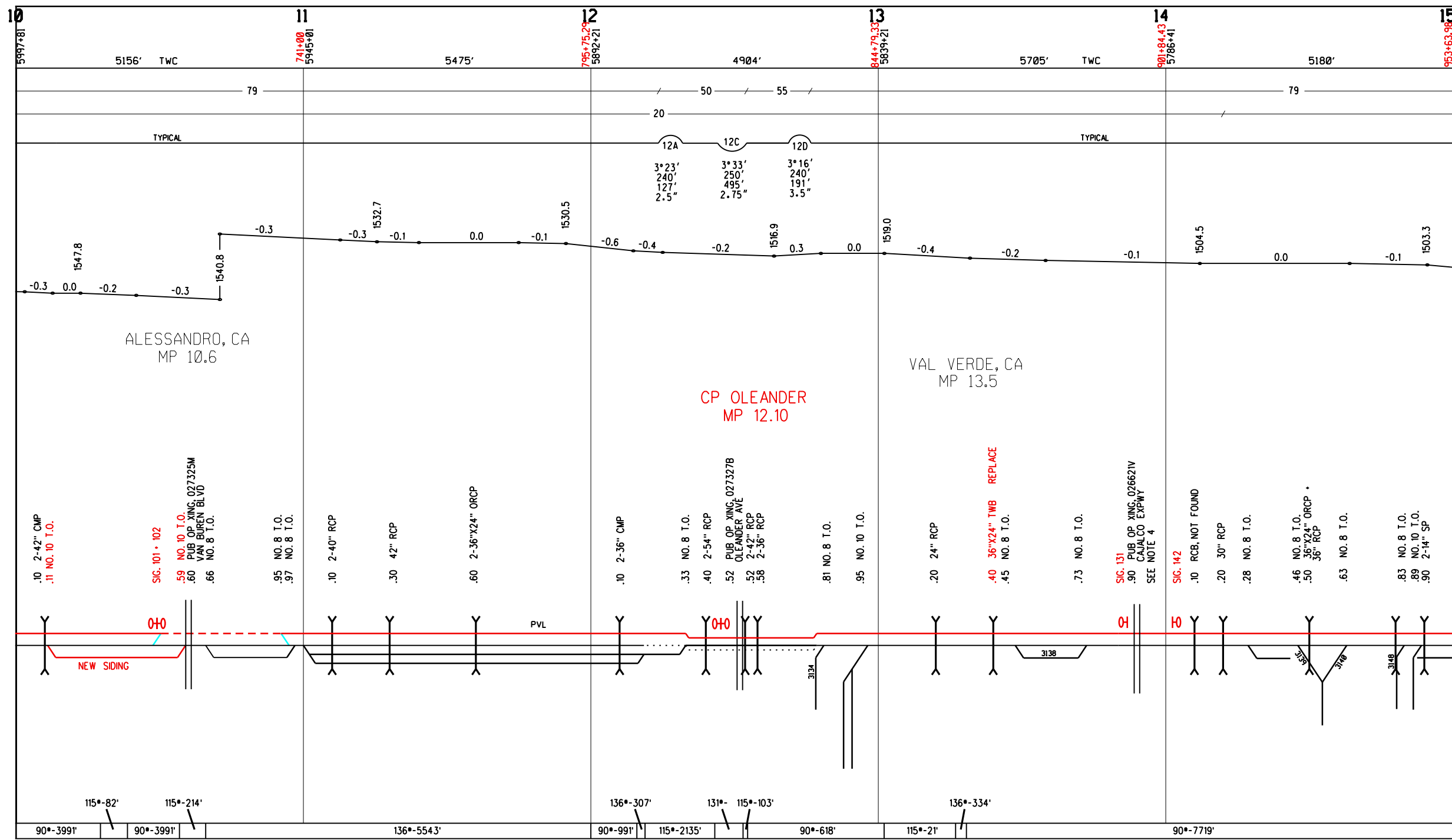

Passenger Speed
Freight Speed

- NOTES:**
1. NEW CONSTRUCTION - REFERS TO A NEW TRACK CONSTRUCTED WHERE THERE IS NO TRACK AT PRESENT.
 2. TRACK UPGRADES - REFERS TO A COMPLETE REPLACEMENT OF THE EXISTING TRACK WITH NEW 136 LB CWR AND CONCRETE TIES.
 3. EXISTING MAIN TRACK - REFERS TO TRACKS THAT REMAIN IN PLACE; IF NECESSARY THE TRACK STRUCTURE WILL BE IMPROVED THROUGH SELECTIVE REPAIR, REHABILITATION, AND OR REPLACEMENT OF TURNOUTS, ROAD CROSSINGS, BALLAST, AND CROSS TIES.
 4. ALL FREIGHT SPEEDS ARE CURRENT TIME TABLE SPEEDS.

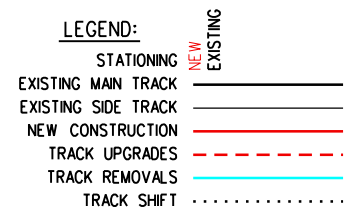

5/15/2009 6:55:49 AM USER = Acp01
 J:\Projects\STV\Drawings\PV206-S-W-204.sht
 J:\Caddconfig\Plot_Drivers\SCRRA_PDF_Color_Halftone.plt

NOT FOR CONSTRUCTION

REV.	DATE	BY	APP.
5-19-09	PRELIMINARY (30%) DESIGN		

INFORMATION CONFIDENTIAL
 All plans, drawings, specifications, and/or information furnished herewith shall remain the property of the Riverside County Transportation Commission and shall be held confidential and shall not be used for any purpose not provided for in agreements with the Riverside County Transportation Commission.

DESIGNED BY
R. ITURALDE

DRAWN BY
R. ITURALDE

CHECKED BY
P. MAHONEY

APPROVED BY
MZ. GHANDEHARI

DATE
5-19-09

RCTC RIVERSIDE COUNTY TRANSPORTATION COMMISSION

STV Incorporated
 ENGINEERS, ARCHITECTS, PLANNERS/CONSTRUCTION MANAGERS
 9130 ANAHEIM PLACE, SUITE 210
 RANCHO CUCAMONGA, CA. 91730-8540

PATTERSON & ASSOCIATES, INC.
 725 TOWN & COUNTRY RD
 SUITE 300
 ORANGE, CA 92668

RCTC PERRIS VALLEY LINE

SCHEMATIC SHEET 4 OF 6

CONTRACT NO. C07-33-123-00	
DRAWING NO. S	DISCIPLINE/SEQUENCE W-204
REVISION	SHEET NO. 41 OF 1140
SCALE	NOT TO SCALE

5/15/2009 6:55:50 AM USER = Acraft
 J:\Projects\15\15\Drawings\15-06-5-W-205.sht
 J:\Caddconfig\Plot_Drivers\SCRRA_PDF_Color_Half.plt

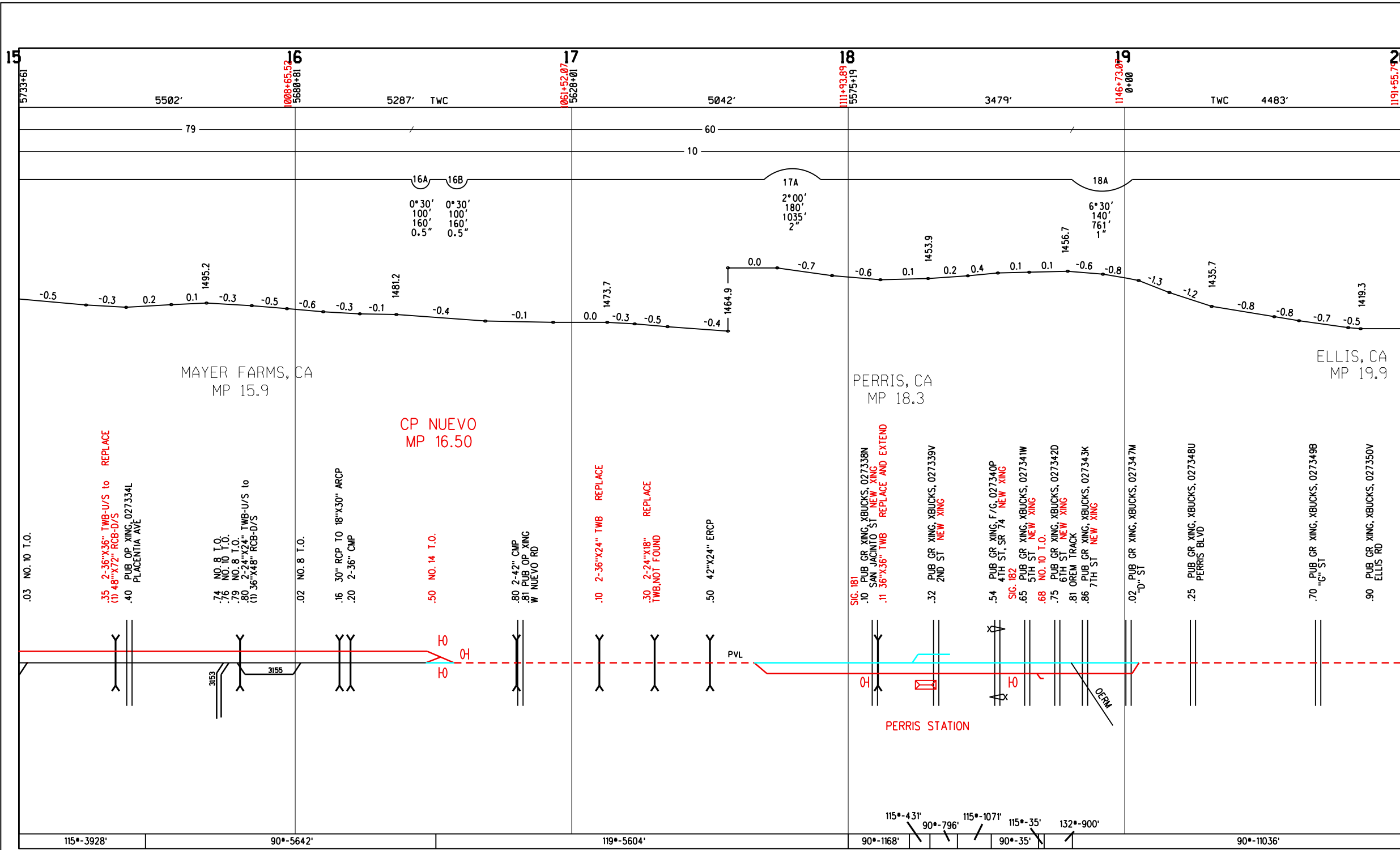

Passenger Speed
 Freight Speed

- NOTES:**
1. NEW CONSTRUCTION - REFERS TO A NEW TRACK CONSTRUCTED WHERE THERE IS NO TRACK AT PRESENT.
 2. TRACK UPGRADES - REFERS TO A COMPLETE REPLACEMENT OF THE EXISTING TRACK WITH NEW 136 LB CWR AND CONCRETE TIES.
 3. EXISTING MAIN TRACK - REFERS TO TRACKS THAT REMAIN IN PLACE; IF NECESSARY THE TRACK STRUCTURE WILL BE IMPROVED THROUGH SELECTIVE REPAIR, REHABILITATION, AND OR REPLACEMENT OF TURNOUTS, ROAD CROSSINGS, BALLAST, AND CROSS TIES.
 4. ALL FREIGHT SPEEDS ARE CURRENT TIME TABLE SPEEDS.

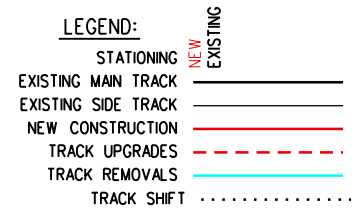

NOT FOR CONSTRUCTION

REV.	DATE	DESCRIPTION	BY	APP.
5-19-09		PRELIMINARY (30%) DESIGN		

INFORMATION CONFIDENTIAL
 All plans, drawings, specifications, and/or information furnished herewith shall remain the property of the Riverside County Transportation Commission and shall be held confidential and shall not be used for any purpose not provided for in agreements with the Riverside County Transportation Commission.

DESIGNED BY
R. ITURALDE

DRAWN BY
R. ITURALDE

CHECKED BY
P. MAHONEY

APPROVED BY
MZ. GHANDEHARI

DATE
5-19-09

RCTC RIVERSIDE COUNTY TRANSPORTATION COMMISSION

STV Incorporated
 ENGINEERS, ARCHITECTS, PLANNERS/CONSTRUCTION MANAGERS
 9130 ANAHEIM PLACE, SUITE 210
 RANCHO CUCAMONGA, CA. 91730-8540

PATTERSON ASSOCIATES, INC.
 725 TOWN & COUNTRY RD
 SUITE 300
 ORANGE, CA 92668

RCTC PERRIS VALLEY LINE

SCHEMATIC SHEET 5 OF 6

CONTRACT NO. C07-33-123-00	
DRAWING NO. S	DISCIPLINE/SEQUENCE W-205
REVISION	SHEET NO. 42 OF 1140
SCALE NOT TO SCALE	

5/15/2009 6:55:51 AM USER = Acraft
 J:\Projects\STV\Drawings\W-206-S-W-206.sht
 J:\Caddconfig\Plot_Drivers\PlotStamp.tbl
 J:\Caddconfig\Plot_Drivers\SCRRA_PDF_Color_Half.plt

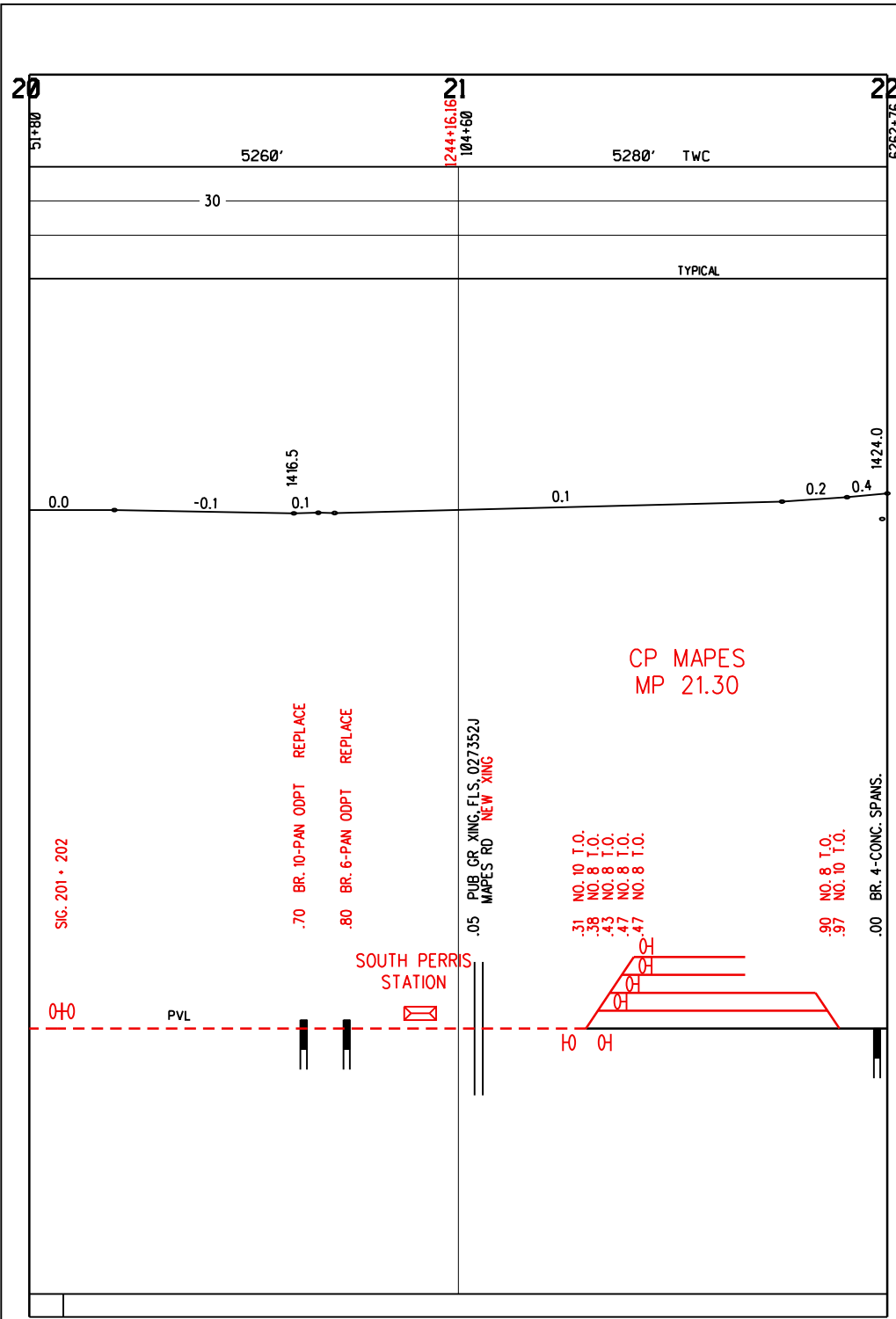

- NOTES:**
1. NEW CONSTRUCTION - REFERS TO A NEW TRACK CONSTRUCTED WHERE THERE IS NO TRACK AT PRESENT.
 2. TRACK UPGRADES - REFERS TO A COMPLETE REPLACEMENT OF THE EXISTING TRACK WITH NEW 136 LB CWR AND CONCRETE TIES.
 3. EXISTING MAIN TRACK - REFERS TO TRACKS THAT REMAIN IN PLACE; IF NECESSARY THE TRACK STRUCTURE WILL BE IMPROVED THROUGH SELECTIVE REPAIR, REHABILITATION, AND OR REPLACEMENT OF TURNOUTS, ROAD CROSSINGS, BALLAST, AND CROSS TIES.
 4. ALL FREIGHT SPEEDS ARE CURRENT TIME TABLE SPEEDS.

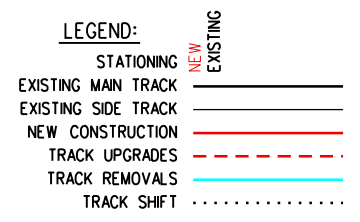

NOT FOR CONSTRUCTION

REV.	DATE	DESCRIPTION	BY	APP.
5-19-09		PRELIMINARY (30%) DESIGN		

INFORMATION CONFIDENTIAL
 All plans, drawings, specifications, and/or information furnished herewith shall remain the property of the Riverside County Transportation Commission and shall be held confidential and shall not be used for any purpose not provided for in agreements with the Riverside County Transportation Commission.

DESIGNED BY
R. ITURALDE

DRAWN BY
R. ITURALDE

CHECKED BY
P. MAHONEY

APPROVED BY
MZ. GHANDEHARI

DATE
5-19-09

RCTC RIVERSIDE COUNTY TRANSPORTATION COMMISSION

STV Incorporated
 ENGINEERS, ARCHITECTS, PLANNERS, CONSTRUCTION MANAGERS
 9130 ANAHEIM PLACE, SUITE 210
 RANCHO CUCAMONGA, CA. 91730-8540

PATTERSON & ASSOCIATES, INC.
 CIVIL, STRUCTURAL, ELECTRICAL ENGINEERING
 725 TOWN & COUNTRY RD.
 SUITE 300
 ORANGE, CA 92868

RCTC PERRIS VALLEY LINE

SCHEMATIC SHEET 6 OF 6

CONTRACT NO. C07-33-123-00	
DRAWING NO. S	DISCIPLINE/SEQUENCE W-206
REVISION	SHEET NO. 43 OF 1140
SCALE NOT TO SCALE	